

# NovAseptic® Mixer Tank Plate, GMP ATEX

Catalogue Number AX###/33

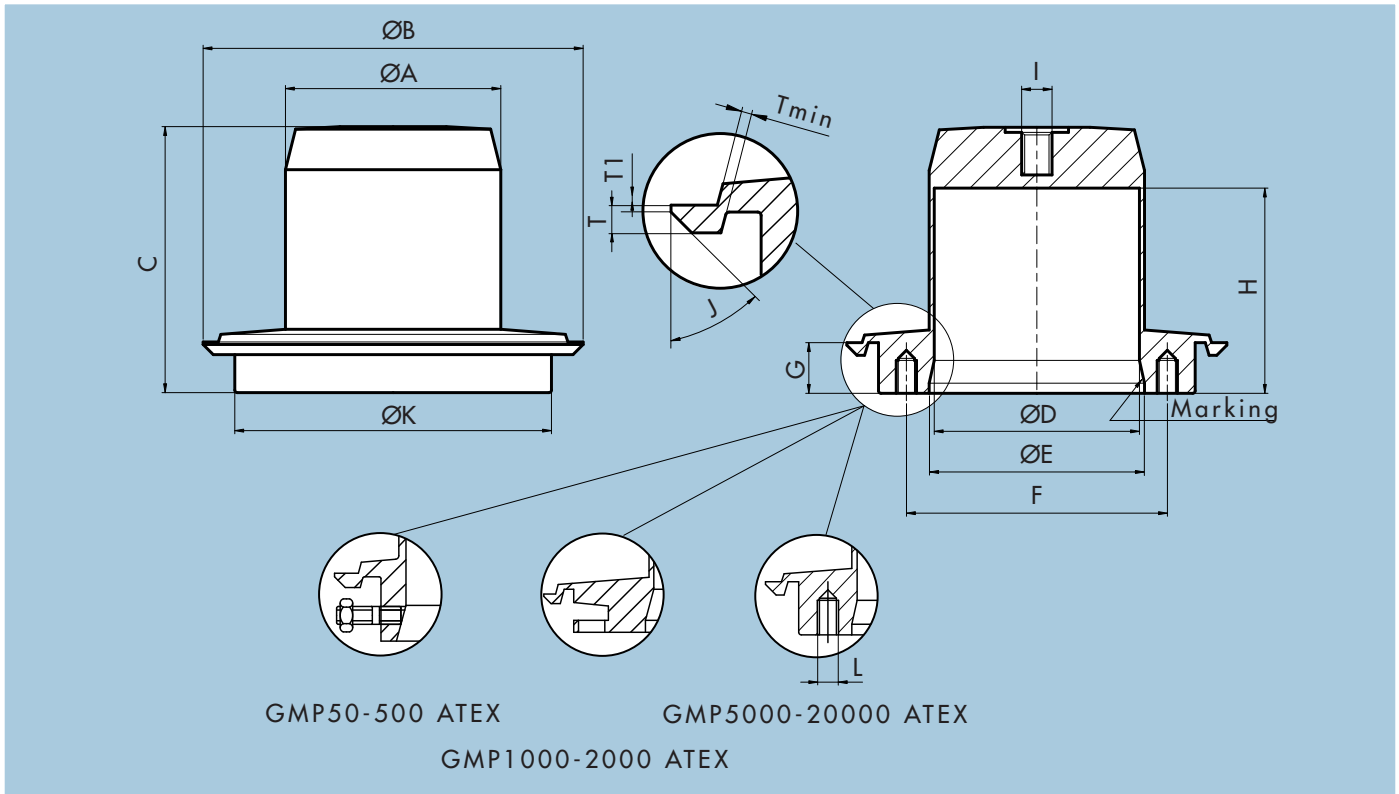

## Tank Plate, GMP ATEX Configuration



Nominal Dimensions in mm (in.)

AX###/33*	A	B	C	D	E	F	G	H	I	J	K	L	T	T1	Tmin	Compatible Mixer
AX05/33	32 (1.26)	72 (2.83)	56 (2.20)	28 (1.10)	38 (1.50)	-	18 (0.71)	44 (1.73)	M6	45°	50 (1.97)	-	3 (0.12)	1 (0.04)	2.5 (0.10)	GMP50 ATEX
AX1/33	54 (2.13)	90 (3.54)	58 (2.28)	50 (1.97)	56 (2.20)	-	19 (0.75)	46 (1.81)	M6	45°	64 (2.52)	-	4 (0.16)	1 (0.04)	1.8 (0.07)	GMP100 ATEX
AX5/33	54 (2.13)	90 (3.54)	68 (2.68)	50 (1.97)	56 (2.20)	-	19 (0.75)	56 (2.20)	M6	45°	64 (2.52)	-	4 (0.16)	1 (0.04)	1.8 (0.07)	GMP500 ATEX
AX10/33	62 (2.44)	150 (5.91)	69 (2.72)	58 (2.28)	65 (2.56)	110 (4.33)	17 (0.67)	56 (2.20)	M6	45°	125 (4.92)	-	4 (0.16)	1 (0.04)	2.2 (0.09)	GMP1000 ATEX
AX20/33	85 (3.35)	150 (5.91)	73 (2.87)	81 (3.19)	85 (3.35)	110 (4.33)	20 (0.79)	58 (2.28)	M10	45°	125 (4.92)	-	4 (0.16)	1 (0.04)	2.3 (0.09)	GMP2000 ATEX
AX50/33	104 (4.09)	160 (6.30)	73 (2.87)	100 (3.94)	104 (4.09)	116 (4.57)	13 (0.52)	54 (2.13)	M12	45°	128 (5.04)	M8	6 (0.24)	1.5 (0.06)	4.2 (0.17)	GMP5000 ATEX
AX100/33	85 (3.35)	150 (5.91)	105 (4.13)	81 (3.19)	85 (3.35)	105 (4.13)	20 (0.79)	81 (3.19)	M12	45°	125 (4.92)	M8	5 (0.20)	1 (0.04)	2.4 (0.09)	GMP10000 ATEX
AX200/33	168 (6.61)	240 (9.45)	94 (3.70)	164 (6.46)	168 (6.61)	187 (7.36)	25 (0.98)	69 (2.72)	M12	45°	207 (8.15)	M10	6 (0.24)	2 (0.08)	5.4 (0.21)	GMP20000 ATEX

\* Note: NovAseptic Gauge 1 (G91-###) and NovAseptic Gauge 2 (G92-###) are included.

**Specifications**

**Net Weight (approximate)**

Tank Plate	AX05/33	AX1/33	AX5/33	AX10/33	AX20/33	AX50/33	AX100/33	AX200/33
Weight kg (lb)	0.5 (1.1)	0.5 (1.1)	0.6 (1.3)	2 (4.4)	2 (4.4)	2.5 (5.51)	3 (6.6)	8 (18)

**Welding Diameter**

	AX05/33	AX1/33	AX5/33	AX10/33	AX20/33	AX50/33	AX100/33	AX200/33
Diameter mm (in)	Ø72 (Ø2.83)	Ø90 (Ø3.54)	Ø90 (Ø3.54)	Ø150 (Ø5.91)	Ø150 (Ø5.91)	Ø160 (Ø6.30)	Ø150 (Ø5.91)	Ø240 (Ø9.45)

**Material**

	Bar Stainless Steel in Compliance with	
Material Code	316L	EN 1.4435
Technical Requirements	ASME® SA-479	EN 10272

**Specifications**

Technical Data:	Class Ex II 1 GD Category 1 Explosion group IIC Temperature T4
Surface Roughness:	Surface Ra ≤ 0.5µm (20µin)
Surface Treatment:	Liquid contact surface, manually polished.
Design Temperature:	-80 to 135 °C (-112 to 275 °F)
Design Pressure:	-1 to 7 bar(g) (-14.5 to 101 psi(g))
Note!	The assembled NovAseptic Mixer may have different design temperature and/or pressure limits. The weakest component in the assembled product determines the maximum design temperature and pressure limits.
Labeling:	Each Tank Plate is individually labeled for full traceability and heat No. according to Millipore QA routines.
Packaging:	The Tank Plate is packaged in a closed box.
Quality Control:	Millipore Quality Assurance System guarantees the control and traceability at all stages of the manufacturing.
In Compliance With:	The NovAseptic Mixer is classified in Europe, for PED Directive 97/23/EC Category IV and approved by Notified Body.
Requirements:	The Tank Plate is designed to meet requirements for USA, ASME VIII Div 2. Stresses in Tank Plate due to internal pressure have been analysed by FEM.

**To Place an Order or Receive Technical Assistance**

For additional information call your nearest Millipore office or visit us at [www.millipore.com](http://www.millipore.com).

In the U.S. and Canada, call toll-free 1-800-MILLIPORE (1-800-645-5476). In the U.S., Canada and Puerto Rico, fax orders to 1-800-MILLIFX (1-800-645-5439).

# MILLIPORE

Millipore and NovAseptic are registered trademarks of Millipore Corporation or an affiliated company.

ASME is a registered trademark of the American Society of Mechanical Engineers.

Specifications subject to change without notice.

Lit. No. SP1184EN00 Rev. -, 12/2006. Replaces DS-273

© 2006 Millipore Corporation. All rights reserved.