

## Specification Sheet

# NovAseptic<sup>®</sup> Mixer, Mixer Assembly, HS ATEX

Catalogue Number:

HS-AXT#-#

## Product Description

The NovAseptic<sup>®</sup> mixers offer a complete solution for mixing throughout the process line and are designed for a wide variety of mixing applications in the pharmaceutical and biotechnology industries.

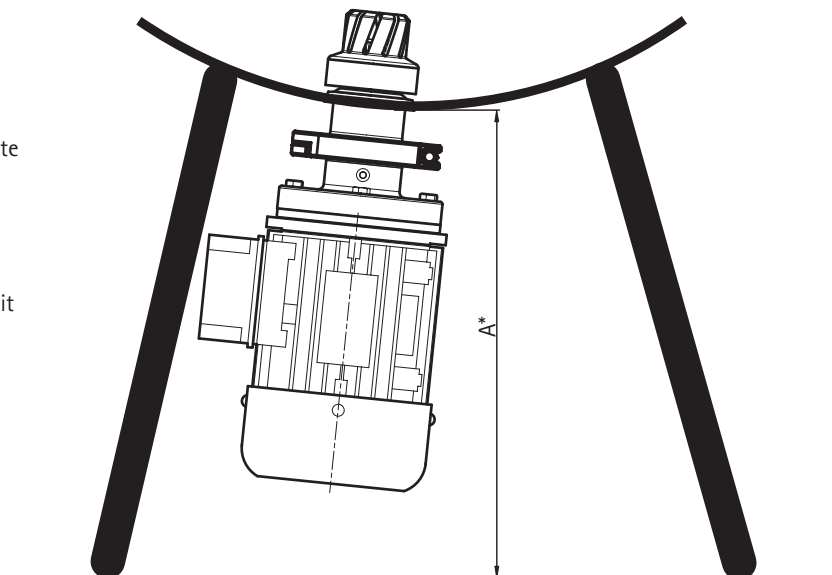
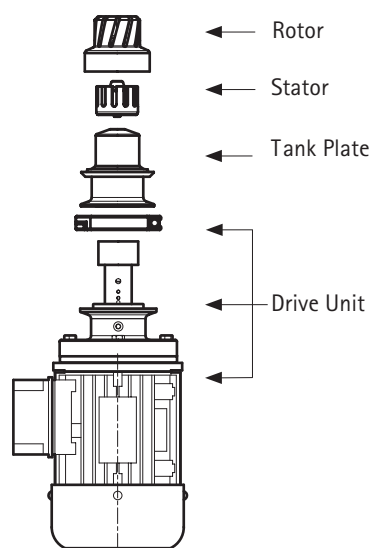

## Catalogue No. Structure



## Nominal Dimensions in mm (in.)

HS Mixer Assembly	Rotor	Stator	Drive Unit	A*	Mixer Model
HS-AXT010-10110	AX10-013	AX20-010	AX40-079	400 (15.75)	HS T10 ATEX
HS-AXT060-10110	AX10-009	AX20-005	AX40-078	600 (23.62)	HS T60 ATEX
HS-AXT260-10110	AX10-010	AX20-007	AX40-071	750 (29.53)	HS T260 ATEX

\*Note: Minimum distance to dismount the Drive Unit

# Specifications

## Net Weight (approximate)

	HS T10 ATEX	HS T60 ATEX	HS T260 ATEX
Mixer Assembly			
Weight kg (lb)	20 (44)	40 (88)	130 (286)

## Max Tip Speed (m/s)

	HS T10 ATEX	HS T60 ATEX	HS T260 ATEX
Mixer Assembly			
Max Tip Speed* (m/s)	11	14	21

## Shear Quota (s<sup>-1</sup>)

	HS T10 ATEX	HS T60 ATEX	HS T260 ATEX
Mixer Assembly			
Shear Rate** (s <sup>-1</sup> )	25000	20000	40000

## Mixer Assembly Parts (included)

	HS - Catalogue No.	Specification Sheet - Lit. No.
Rotor	AX10-#	SP3355EN00
Stator	AX20-#	SP3324EN00
Drive Unit	AX40-#	SP5333EN00

## Mixer Assembly Parts (not included)

	HS - Catalogue No.	Specification Sheet - Lit. No.
Tank Plate (Welded) HS T10 ATEX ***	AX30-001	SP3388EN00
Tank Plate (Welded) HS T60 ATEX ***	AX30-009	SP3389EN00
Tank Plate (Welded) HS T260 ATEX ***	AX30-011	SP3390EN00

## Mixer Accessory Parts (not included)

	HS - Catalogue No.	Specification Sheet - Lit. No.
Attractor HS T10	GT05/AW	SP1178EN00
Attractor HS T60	GT60/AW	SP1178EN00
Lifting Tool for Rotor HS T60	G93-001	SP1176EN00
Stator Mounting Tool	G93-#	SP1177EN00
Welding Tool Tank Plate Heatsink for HS T60 and HS T260	G94-#	SP1179EN00
Control Cabinet	Please contact your local sales representative for additional information.	

\*Note: Tip Speed at Mechanical Limit

\*\* Note: Shear Rate at Mechanical Limit

\*\*\*Note: NovAseptic® Gauge 1 and Gauge 2 are mandatory for tank plate deformation check and shall be ordered separately

## Additional Information

Ambient Temperature*	0 to 40 °C (32 to 104 °F)
Operating Temperature*	5 to 135 °C (41 to 275 °F)
Specification Sheet	Further information is available on the Specification Sheet of each NovAseptic® Mixer Assembly part.
Quality Control	The Quality Assurance System guarantees the control and traceability at all stages of the manufacturing

\*Note: The NovAseptic® Mixer may have different design temperature and/or pressure limits. The weakest component in the assembled product determines the maximum permitted design temperature and pressure limits.





[www.merckmillipore.com](http://www.merckmillipore.com)

Merck Millipore and the M mark are registered trademarks of Merck KGaA, Darmstadt, Germany.  
NovAseptic is a registered trademark of Millipore AB.  
Specifications subject to change without notice.  
Lit. No.SP5334EN00 Rev. B 05/2014 DP SBU-13-08218 Printed in the USA.  
©2014 Millipore Corporation, Billerica, MA 01821 U.S.A. All rights reserved.

## To Place an Order or Receive Technical Assistance

In Europe, please call Customer Service:

France: 0825.045.645  
Spain: 901.516.645 Option 1  
Germany: 01805.045.645  
Italy: 848.845.645

United Kingdom: 0870.900.46.45

For other countries across Europe,  
please call: +44 (0) 115 943 0840

Or visit [www.merckmillipore.com/offices](http://www.merckmillipore.com/offices)

For Technical Service visit:

[www.merckmillipore.com/techservice](http://www.merckmillipore.com/techservice)